

**Swaged - Nipples**

Nominal pipe inches	Outside diameter	Outside diameter	Wall thickness S								Length
			STD		XS		SCH 160		XXS		
	D	d	S	S1	S	S1	S	S1	S	S1	L
1/2X1/4	21,34	13,72	2,77	2,24	3,73	3,02	-	-	-	-	69,85
1/2X3/4		17,15		2,31		3,20					
3/4X1/4	26,67	13,72	2,87	2,24	3,91	3,02	5,54	-	7,82	-	76,20
3/4X3/8		17,15		2,31		3,20					
3/4X1/2		21,34		2,77		3,73					
1X3/8	33,40	17,15	3,38	2,31	4,55	3,20	6,35	-	9,09	-	88,90
1X1/2		21,34		2,77		3,73					
1X3/4	33,40	26,67	3,56	2,87	4,85	3,91	6,35	5,54	9,70	7,82	101,60
1.1/4X1/2		21,34		2,77		3,73					
1.1/4X3/4	42,16	26,67	3,68	2,87	5,08	3,91	7,14	5,54	10,2	7,82	115,00
1.1/4X1		33,40		3,38		4,55					
1.1/2X1/2	48,26	21,34	3,91	2,77	5,54	3,73	8,71	4,75	11,1	7,45	165,10
2X1/2		26,67		2,87		3,91					
2X3/4	60,30	33,40	5,16	3,38	7,01	4,55	9,52	7,14	14,0	10,20	117,80
2/2X1		42,16		3,56		4,85					
2X1.1/4	60,30	48,26	7,62	3,68	8,56	5,03	13,5	8,71	17,1	14,00	228,60
2X1.1/2		21,34		2,77		3,73					
2.1/2X3/4	73,02	26,67	5,49	2,87	7,62	3,91	11,1	7,14	15,2	10,20	203,20
2.1/2X1		33,40		3,33		4,55					
2.1/2X1.1/4	73,02	42,16	6,02	3,56	8,56	4,85	13,5	9,52	17,1	14,00	228,60
2.1/2X1.1/2		48,26		3,68		5,03					
2.1/2X2	60,30	3,91	5,54	8,71	11,10	14,00	17,10	21,90	19,00	304,80	
3X1	88,90	33,40	5,49	3,38	7,62	4,55	11,1	7,14	15,2	10,20	203,20
3X1.1/4		42,16		3,56		4,85					
3X1.1/2	88,90	48,26	6,02	3,68	8,56	5,03	13,5	9,52	17,1	14,00	228,60
3X2		60,30		3,91		5,54					
3X2.1/2	88,90	73,02	7,11	5,16	11,0	7,01	18,2	13,50	21,9	17,10	304,80
4X1		33,40		3,38		4,55					
4X1.1/4	114,30	42,16	6,02	3,56	8,56	4,85	13,5	9,52	17,1	14,00	228,60
4X1.1/2		48,26		3,68		5,03					
4X2	114,30	60,30	7,11	3,91	11,0	5,54	18,2	13,50	21,9	17,10	304,80
4X2.1/2		73,02		5,16		7,01					
4X3	168,30	88,90	7,11	5,49	11,0	7,62	18,2	13,50	21,9	17,10	304,80
6X2		60,30		3,91		5,54					
6X3	168,30	88,90	7,11	5,49	11,0	7,62	18,2	13,50	21,9	17,10	304,80
6X4		114,30		6,02		8,56					
6X5	141,30	6,55	9,52	13,50	19,00	25,40	37,70	49,90	55,40	-	

**Caps**

Nominal pipe inches	Outside diam.	Wall thickness				Height		Unitary weight			
		STD	XS	SCH	XXS	H	H1	STD	XS	SCH	XXS
1/2"	21,34	2,77	3,73	4,75	7,45	25,40	25,40	0,03	0,04	0,10	0,12
3/4"	26,67	2,87	3,91	5,54	7,82	31,70	31,70	0,05	0,08	0,13	1,18
1"	33,40	3,38	4,55	6,35	9,09	38,10	38,10	0,09	0,12	0,17	0,20
1.1/4"	42,16	3,56	4,85	6,35	9,70	38,10	38,10	0,14	0,18	0,24	0,28
1.1/2"	48,26	3,68	5,08	7,14	10,20	38,10	38,10	0,16	0,22	0,33	0,36
2"	60,30	3,91	5,54	8,71	11,10	38,10	44,00	0,23	0,31	0,43	0,59
2.1/2"	73,02	5,16	7,01	9,52	14,00	38,10	51,00	0,36	0,46	0,67	0,99
3"	88,90	5,49	7,62	11,10	15,20	50,80	64,00	0,64	0,85	1,22	1,78
3.1/2"	101,60	5,74	8,08	12,20	16,15	63,50	76,20	0,96	1,30	3,63	2,63
4"	114,30	6,02	8,56	13,50	17,10	63,50	76,00	1,15	1,57	2,68	3,17
5"	141,30	6,55	9,52	15,90	19,00	76,20	88,90	1,88	2,64	5,92	6,52
6"	163,30	7,11	11,00	18,20	21,90	88,90	102,00	2,91	4,28	16,98	18,47
8"	219,20	8,18	12,70	23,00	22,20	101,60	127,00	5,07	7,56	25,50	23,40
10"	273,00	9,27	12,70	28,60	-	127,00	152,40	9,00	12,10	51,50	-
12"	323,80	9,52	12,70	33,30	-	152,40	177,80	13,30	17,20	95,80	-
14"	355,60	9,52	12,70	35,70	-	165,10	190,50	16,00	20,50	140,70	-
16"	406,40	9,52	12,70	40,50	-	177,80	203,20	20,20	26,10	204,50	-
18"	457,20	9,52	12,70	45,20	-	203,20	228,60	25,90	33,50	281,70	-
20"	508,00	9,52	12,70	50,00	-	228,60	254,00	32,10	42,50	445,30	-
22"	558,80	9,52	12,70	54,00	-	254,00	266,70	37,70	49,90	550,40	-
24"	609,60	9,52	12,70	59,50	-	266,70	304,80	46,20	59,30	760,60	-

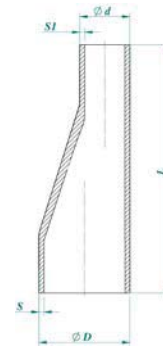
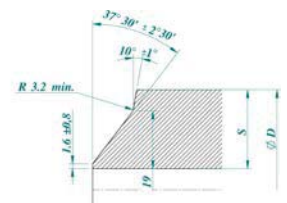
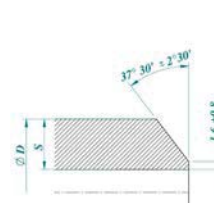
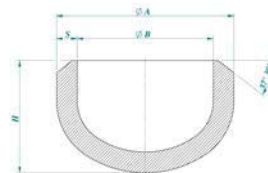

Particolari di smusso per raccordi con spessore fino a 19,5mm compreso  
Particular of beveling for fittings with thickness up to 19,5mm included

**TOLLERANZE DIMENSIONALI  
ASA B16.9**  
**DIMENSIONAL TOLERANCES  
TO ASA B16.9**

Particolari di smusso per raccordi con spessore superiore a 19,5mm  
Particular of beveling for fittings with thickness superior to 19,5mm

**Notes:**

- 1) All dimensions are in m/m.
- 2) The swage of present table are supplied by request, with threading GAS or NPT.
- 3) Materials in conformity with ASTM. Dimensional tolerances as per ASA 16.9.
- 4) For caps: the data of the column H refers to caps of thickness <= XS.
- 5) For caps: the data of the column H1 refers to caps of thickness > XS.
- 6) Obtained from solid material (not stamped).