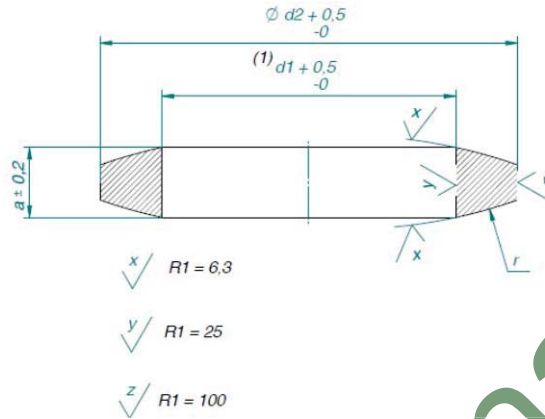

DIN 2696

	D1		D2	a	r
	min	max			
ND 64 - 400					
10	10	14	21	7	25
15	14	18	28	8,5	32
25	20	29	43	11	50
40	34	43	62	14	70
50	46	55	78	16	88
65	62	70	102	20	112
80	72	82	116	22	129
100	94	108	143	26	170
125	116	135	180	29	218
150	139	158	210	33	250
ND 64 - 100					
175	176	183	243	31	296
200	198	206	276	35	329
250	246	257	332	37	406
300	295	305	385	40	473
350	330	348	425	41	538
400	385	395	475	42	610
ND 160 - 400					
175	162	177	243	37	296
200	183	200	276	40	329
250	230	246	332	46	406
300	278	285	385	50	473

Notes:

1) Internal diameters must be notified by the customer's request.

Sabic
SF2-25-310-1310 rev0

Size	Dimension detail (in mm)				
	Outside diam.	Inside diam.	Width	Width	Radius
	D1	D2	W1	W2	R
1/2"	22	11,84	7,5	3,5	24,0
3/4"	27	15,60	9,0	4,5	29,6
1"	33	20,70	10	5,2	37,7
1.1/2"	50	33,99	13,0	6,8	59,2
2"	61	42,90	14,5	7,5	72,9
3"	95	66,65	20,0	9,0	112,3
4"	118	87,33	23,5	11,6	141,9
6"	174	131,80	30,0	13,6	210,5
10"	283	215,90	41,0	14,9	343,5

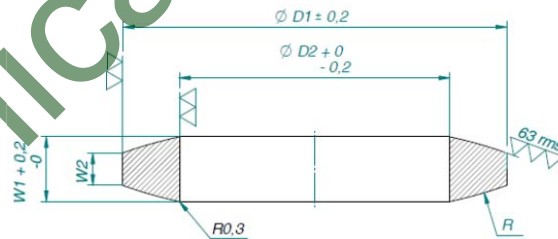
Notes:

1) Outer periphery of each lens gasket (one half) shall have permanent marking or etching containing following information:

size, material size, manufacturer name, sabic po number

2) The other half of outer periphery shall have permanent color code as per table. The color paint shall not contain any content (such as chlorides) which is injurious to the lense gasket material.

3) Material certification to be provided in accordance with stamicarbon specifications 18005 and 53961 latest revision.

5) Each DN can be supplied having color code as follows:

BC01	Pink
BC02	Red
BC03	blue